

GEDORE

TOOLS FOR LIFE

Belt Tool Series



KL-0183-71 K
KL-0183-70 K
KL-0366-15 A
KL-0149-131

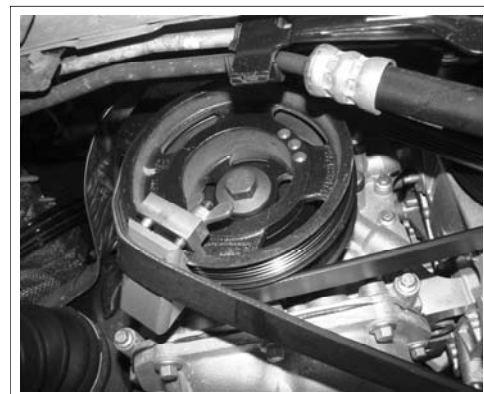

0183-71Ke151105.docx

GEDORE Automotive GmbH

Breslauer Straße 41
78166 Donaueschingen

Postfach 1329
78154 Donaueschingen - GERMANY

Phone.: +49 (0) 771 / 8 32 23-0
Fax: +49 (0) 771 / 8 32 23-90

Email: info@gedore-automotive.com
Internet: www.gedore.com

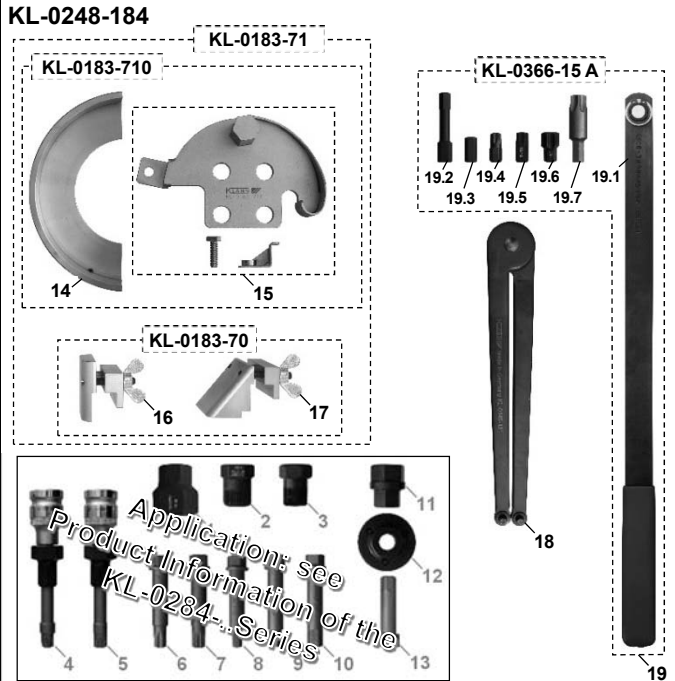

When using the...
KL-0183-71 Tool Kit for Elastic V-Ribbed Belts, refer to page 2 - 3
KL-0149-131 Pin-Type Face Spanner, refer to page 4
KL-0366-15 A Special Wrench Set, refer to page 4

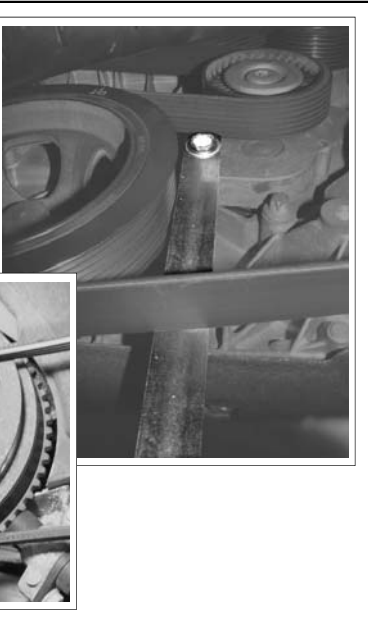

KL-0284-184 Alternator & Belt Tool Set

Universally applicable to: VW-Audi, Seat, Škoda, BMW, Alfa Romeo, Dacia, Fiat, Ford, Mazda, Mercedes, Peugeot, Porsche, Renault, Toyota, Volvo, Opel/Vauxhall etc.

Field of Application

The **KL-0284-184 E** alternator and belt tool set allows for the easy and professional loosening/tightening of hard-to-access screws on fan clutches, pulleys/tensioner pulleys. The kit also includes tools for the removal/installation of overrunning alternator pulleys. An indispensable tool set, for example, when changing an alternator or pulley, as well as when removing/installing elastic ribbed V-belts.

Scope of Delivery

Pos.	Part No.	Description	Qty
-	KL-0284-184	Alternator and Belt Tool Set	1
<i>composed of:</i>			
-	KL-0183-71	Tool Kit for Elastic V-Ribbed Belts	1
18	KL-0149-131	Pin-Type Face Spanner, Ø 14-100mm, Pin Ø 5mm	1
19	KL-0366-15 A	Special Wrench Set	1
Application of tools from Pos. 1 - 13, see Product Information of the KL-0284-.. Series			
1	KL-0284-2702	Union Nut, Size (waf) 28mm	1
2	KL-0284-1902	Union Nut (Multi-Tooth), 33 Teeth	1
3	KL-0284-4202	Union Nut (Multi-Tooth), 32 Teeth	1
4	KL-0284-40	Alternator Combination Socket, T50	1
5	KL-0284-41	Alternator Combination Socket, XZN-M10	1
6	KL-0284-2901	Screwdriver Bit Socket, T50	1
7	KL-0284-2801	Screwdriver Bit Socket, XZN-M10	1
8	KL-0284-2811	Screwdriver Bit Socket, Size (waf) 6mm	1
9	KL-0284-2821	Screwdriver Bit Socket, Size (waf) 8mm	1
10	KL-0284-2831	Screwdriver Bit Socket, Size (waf) 10mm	1
11	KL-0284-3901	Union Nut, Size (waf) 17mm	1
12	KL-0284-3902	Union Nut with 3 Pins	1
13	KL-0284-2601	Screwdriver Bit Socket, Size (waf) 10mm	1
Pos.	Part No.	Description	Qty
-	KL-0183-71	Tool Kit for Elastic V-Ribbed Belts	1
<i>composed of:</i>			
-	KL-0183-710	Tool Kit for Elastic V-Ribbed Belts	1
-	KL-0183-70	Tool Kit for V-Ribbed Belts	1
Pos.	Part No.	Description	Qty
-	KL-0183-710	Tool Kit for Elastic V-Ribbed Belts	1
<i>composed of:</i>			
14	KL-0183-712	Belt Guide Tool, Ford, Volvo	1
15	KL-0183-711	Belt Installation Tool, Ford, Volvo	1
Pos.	Part No.	Description	Qty
-	KL-0183-70	Tool Kit for V-Ribbed Belts	1
<i>composed of:</i>			
16	KL-0183-702	V-Ribbed Belt Installation Tool	1
17	KL-0183-701	V-Ribbed Belt Removal Tool	1
Pos.	Part No.	Description	Qty
19	KL-0366-15 A	Special Wrench Set	1
<i>composed of:</i>			
19.1	KL-0366-100	Special Spanner, 8mm Drive	1
19.2	KL-0366-10	Hex Socket Insert, 10mm	1
19.3	KL-0366-20	Hex Socket Insert, 8mm	1
19.4	KL-0366-30	Torx® Insert, T45	1
19.5	KL-0366-121	Torx® Insert, T50	1
19.6	KL-0366-111	Torx® Insert, T60	1
19.7	KL-0366-131	Torx® Insert, T60x40mm	1

KL-0284-184 E Alternator and Belt Tool Set, in a Foam Insert

Like the **KL-0284-184**, however supplied in foam insert **KL-0284-1849-2**. The special foam insert is designed to keep the tools of the **KL-0284-184 E** alternator and belt tool set always properly organised and well protected.

KL-0284-184 K Alternator and Belt Tool Set, in a Plastic Storage Case

Like the **KL-0284-184 E**, however supplied in plastic storage case **KL-0186-1419-1** with foam case lid insert **KL-0186-1419-3**.

KL-0183-71 K



Scope of Delivery: KL-0183-71

KL-0183-710

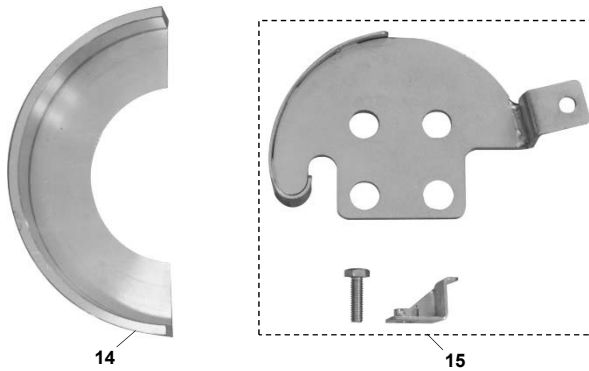

KL-0183-70



Example of use:

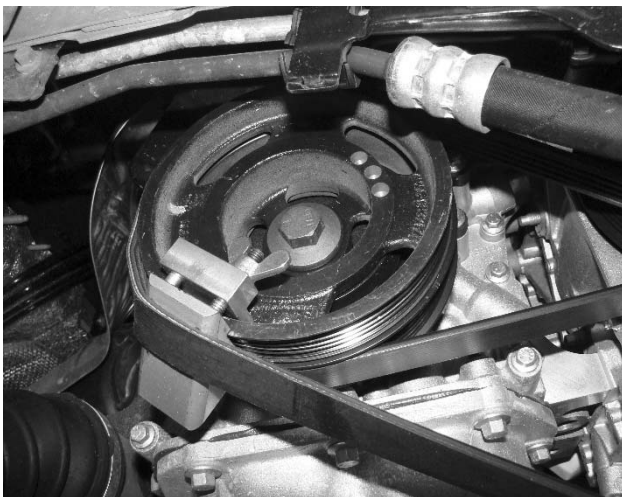

KL-0183-71 K Tool Kit for Elastic V-Ribbed Belts

Universally applicable to BMW, VW, Škoda, Fiat, Ford, Peugeot, Citroën, Chrysler, Renault, Dacia, Mazda and Volvo engines with elastic V-ribbed belt, both with single and double pulley on the crankshaft.

Field of Application

This tool set is indispensable for the quick and easy removal and installation of elastic ribbed V-belts.

Without the use of this tool, the professional removal and installation of these belts is virtually impossible as the belt guide has no tensioning element and, therefore, releasing the belt tension is not possible.

⇒ Single Pulley: (KL-0183-70)

The belt is fitted via the crankshaft pulley, for example, with: BMW 1 Series (E81, E87), 3 Series (E46, E90, E91, E92, E93), 5 Series (E60, E61), 6 Series (E63, E64), 7er (E65, E66), X3 (E83), X5 (E53, E70), X6 (E71, E72); Chrysler Voyager III (RG); Citroën C2 (JM), C3 (FC, HB), C4 (LC, LA, UA, UD), Jumper; Dacia Logan / MCV; Fiat Doblo (119, 223), Ducato (244), Fiorino, Linea, Palio (178BX), Stilo (192), Strada (178E); Ford Fiesta V (JH, JD), Focus II / C-Max (DA, DAW), Fusion (JU); Mazda 2 (DY), 3 (BK12, BK14), 5 (CR19); Peugeot 206 CC (2D), 207 (WA, WC, WD), 307 (3A/C, 3E, 3H), Boxer; Renault Logan (LS); Škoda Fabia; Volvo C30 (533), S40 II (MS), V50 (MV); VW Polo (9N).

⇒ Double Pulley: (KL-0183-710)

The belt is fitted via the water pump pulley, for example, with: Ford Focus II / C-Max (DA, DAW); Volvo C30 (533), S40 II (MS), V50 (MV). (Engine codes: ASDA, ASDB, HWDA, HWDB, SHDA, SHDB, SHDC, HXDA, HXDB, SIDA, B4164 S3)

Scope of Delivery

Pos.	Part No.	Description	Qty
-	KL-0183-71 K	Tool Kit for Elastic V-Ribbed Belts	1
<i>composed of:</i>			
-	KL-0183-710	Tool Kit for Elastic V-Ribbed Belts	1
-	KL-0183-70	Tool Kit for V-Ribbed Belts	1
-	KL-0183-7190	Plastic Storage Case	1
Pos.	Part No.	Description	Qty
-	KL-0183-710	Tool Kit for Elastic V-Ribbed Belts	1
<i>composed of:</i>			
14	KL-0183-712	Holding Tool	1
15	KL-0183-711	V-Ribbed Belt Installation Tool	1
Pos.	Part No.	Description	Qty
-	KL-0183-70	Tool Kit for V-Ribbed Belts	1
<i>composed of:</i>			
16	KL-0183-702	V-Ribbed Belt Installation Tool	1
17	KL-0183-701	V-Ribbed Belt Removal Tool	1

KL-0183-710 K Tool Kit for Elastic V-Ribbed Belts

- Like the KL-0183-710, however supplied in Plastic Storage Case KL-0183-7190.

KL-0183-70 K Tool Kit for Elastic V-Ribbed Belts

- Like the KL-0183-70, however supplied in Plastic Storage Case KL-0183-7090.

⚠ Warnings and Notes

- Do not attempt to start the engine whilst tools of tool kit for elastic V-ribbed belts are still mounted.
- Any work on vehicles should only be performed by qualified specialist personnel observing and complying with the directions, provisions, and safety regulations specified by the vehicle manufacturer!
- Always refer to the vehicle manufacturer's data and instructions as only these apply to all work that is carried out on the vehicle.
- All vehicle-specific data stated herein are supplied under reserve and without commitment.

Fig. 1: **Removing** the belt using the V-ribbed belt removal tool.

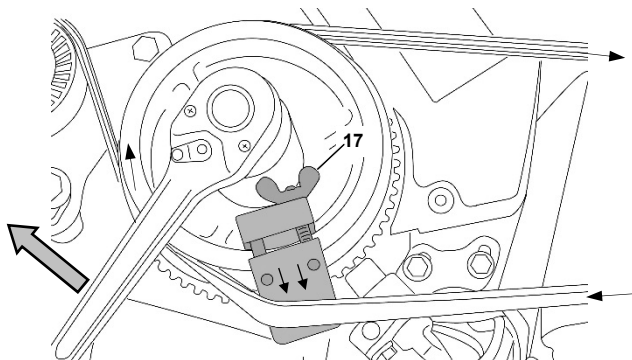

Fig. 2: **Installing** the belt using the V-ribbed belt installation tool.

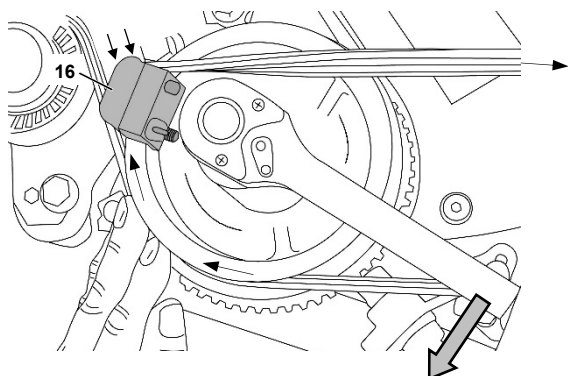
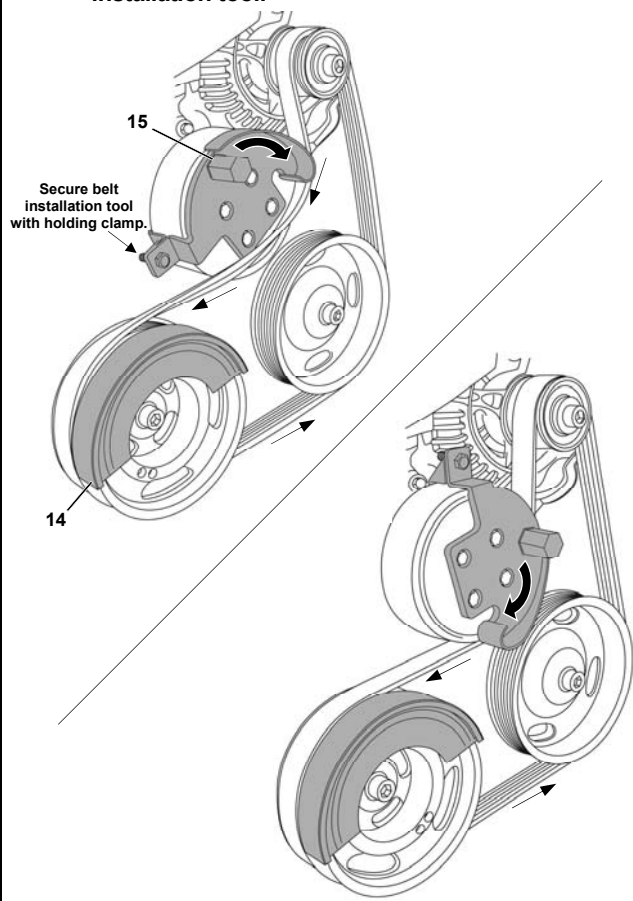

Fig. 3: **Installing** the belt using the belt guide tool and belt installation tool.



Application examples:

V-Ribbed Belt Removal/Installation with the aid of the KL-0183-70 Tool Kit for V-Ribbed Belts:

Belt Removal:

1. Mount V-ribbed belt removal tool “17” to crankshaft pulley as shown in Fig. 1.
2. Manually turn crankshaft with the aid of a reversible ratchet provided with an appropriate socket, and remove V-ribbed belt.

Belt Installation:

1. Mount V-ribbed belt installation tool “16” to crankshaft pulley as shown in Fig. 2.
2. Manually turn crankshaft with the aid of a reversible ratchet provided with an appropriate socket, and fit V-ribbed belt on crankshaft pulley.

V-Ribbed Belt Installation with the aid of the KL-0183-710 Tool Kit for Elastic V-Ribbed Belts:

Belt Installation:

1. Mount belt guide tool “14” to crankshaft pulley as shown in Fig. 3.
2. Mount belt installation tool “15” to water pump pulley and secure with holding clamp as shown in Fig. 3.
3. Manually turn belt installation tool “15” with the aid of a reversible ratchet provided with an appropriate socket, and fit V-ribbed belt, via belt installation tool “15”, on pulley. (Fig. 3)

KL-0366-15 A

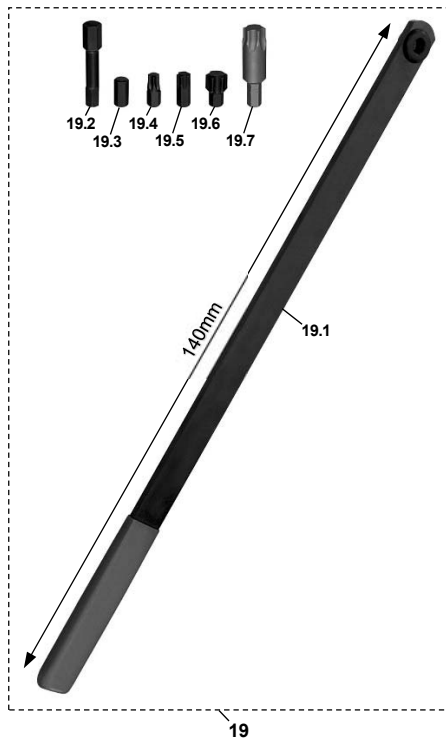

Example of use:



KL-0149-131

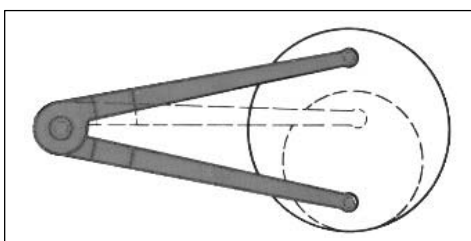
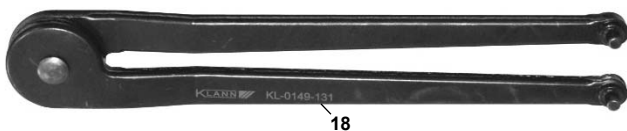

KL-0366-15 A - Special Wrench Set

Universal application.

Field of Application

Designed to loosen and tighten hard-to-reach screws on fan clutches, pulleys, tensioner pulleys etc.

Use wrench in conjunction with the KL-0366-10 10mm hexagon socket insert

for the Mercedes engines M102, M103, OM601, OM602, OM603, OM605 and OM606.

For loosening the screws on compressor pulleys.

Use wrench in conjunction with the KL-0366-20 8mm hexagon socket insert

for the Mercedes engines M102, M103, OM601, OM602, OM603, OM605 and OM606.

For loosening and tightening the fan clutch and pulley at the water pump.

Use wrench in conjunction with the KL-0366-30 Torx® socket insert T45

for the Renault 2.2 Diesel engines (G8T), e.g. in Espace, Laguna, Safrane etc.

When removing and installing a V-belt, the automatic tensioner pulley needs to be tensioned by means of the special wrench so as to release the tension on the V-belt.

Use wrench in conjunction with the KL-0366-121 Torx® socket insert T50

For the Renault 1.4/1.6 litre TwinCam petrol engines (engine code: K4J, K4M) as found in Clio III, Megane / Scenic II, Laguna II, Modus and Kangoo.

For removing and installing the idler pulley, for example, when replacing a timing belt or performing an engine repair.

Use wrench in conjunction with the KL-0366-111 Torx® socket insert T60

for the BMW 5-Series (E60) 2.0 (M54) petrol engines and Mercedes C-Class (W203) 1.8 (OM271) petrol engines etc.

When removing and installing a V-belt, the automatic tensioner pulley needs to be tensioned by means of the special wrench so as to release the tension on the ribbed V-belt.

Use wrench in conjunction with the KL-0366-131 Torx® socket insert T60x40

for the VW-Audi 2.7 and 3.0 V6 TDI Diesel engines, as found in Audi A4, A5, A6, A8, Q5 and Q7; VW Phaeton and Touareg.

For removing and installing the idler pulley, for example, when replacing a timing belt or performing an engine repair.

Scope of Delivery

Pos.	Part No.	Description	Qty
19	KL-0366-15 A	Special Wrench Set	1
<i>composed of:</i>			
19.1	KL-0366-100	Special Wrench, 8mm Drive	1
19.2	KL-0366-10	Hex Socket Insert, 10mm	1
19.3	KL-0366-20	Hex Socket Insert, 8mm	1
19.4	KL-0366-30	Torx® Insert, T45	1
19.5	KL-0366-121	Torx® Insert, T50	1
19.6	KL-0366-111	Torx® Insert, T60	1
19.7	KL-0366-131	Torx® Insert, T60x40mm	1

= registered trademark of Acument Intellectual Properties, LLC. USA

KL-0149-131 Pin-Type Face Spanner, Ø 14-100mm, Pin Ø 5mm

Applicable to VW-Audi engines: 1.9 TDI/PD, 2.0 TDI/PD, 2.5 TDI, 2.7 Turbo, 3.0 TFSI/TSI etc.

Field of Application

Designed to hold the pulley in position when removing/installing the Viscous Fan; suitable for use on many VW-Audi engines.

Technical Data

14-100	5	6	215	6	300

- de Produkt-Information komplett durchlesen und verstehen.
- en Carefully read the Product Information and make sure you have understood it correctly.
- fr Lisez entièrement l'information produit et assurez-vous de l'avoir bien comprise.



- de Vorschriften und Hinweise beachten
- en Observe warnings and notes
- fr Respecter les prescriptions et les remarques.



- de **Sicherheitsvorkehrungen treffen**
 - Werkzeug mit Sicherheitshaltegurt gegen Herunterfallen sichern.
 - Schutzausrüstungsvorgaben der Berufsgenossenschaft beachten.
- en **Ensure all safety measures are in place to avoid injury/potential hazards**
 - Secure the hydraulic cylinder with a safety belt to prevent it from falling.
 - Always follow the procedures and precautions within the operator instruction manual; failure to do this could result in serious injury and could invalidate your warranty and insurance.
- fr **Prendre toutes les mesures de sécurité nécessaires**
 - Sécuriser le cylindre hydraulique contre les chutes à l'aide de la sangle de sécurité.
 - Respecter les prescriptions du Syndicat Professionnel en matière d'équipements de protection.

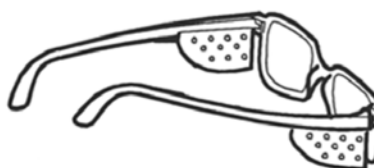
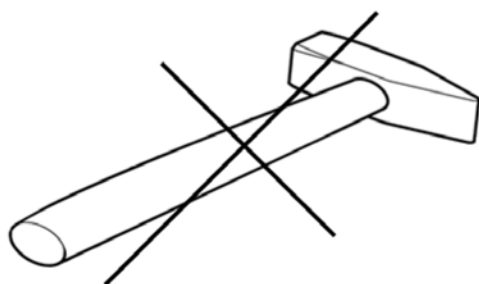

- de Pflege und Reinigung
- en Care and cleaning
- fr Entretien et nettoyage



GEDORE

WERKZEUGE FÜRS LEBEN

GEDORE Automotive GmbH

Breslauer Strasse 41
78166 Donaueschingen

Postfach 1329
78154 Donaueschingen - GERMANY

Tel.: +49 (0) 771 / 8 32 23-0
Fax: +49 (0) 771 / 8 32 23-90

E-Mail: info@gedore-automotive.com
Internet: www.gedore.com