

RA12M-C

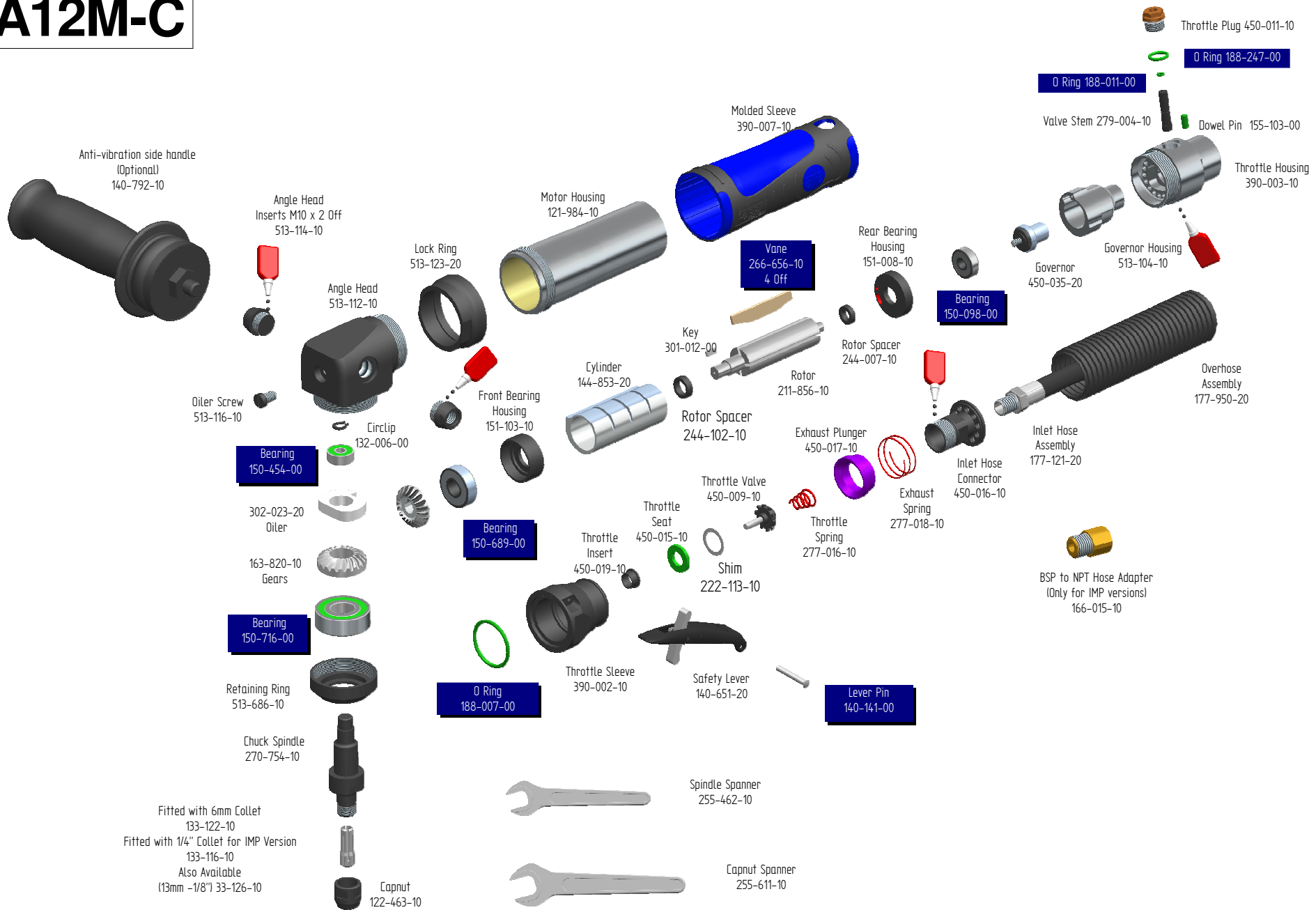

Fitted with 6mm Collet 133-122-10
 Fitted with 1/4" Collet for IMP Version 133-116-10
 Also Available (13mm -1/8") 33-126-10

MOTOR SERVICE KIT

All parts shown highlighted with a blue box are included in service kit 555-205-20

STRIPPING TOOL SET PART NUMBER 900-560-20

MODEL	R.P.M	m3/min	kg	dB(A)	m/s ²
RA12M-C	12000	0.71	1.19	77.0	<2.5

This Symbol indicates 242 Loctite Required