

AT-4265

Wheel Hub / Wheel Bearing Units Tool Set

- For removing and installing the wheel hub or wheel bearings of **built-in** parts on cars.
- Suitable for cars with Ø 72mm wheel bearings.
- The design can prevent damage to the new wheel bearing because it provides safe and accurate centering and alignment when changing wheel bearings.
- For Audi-A1 、A2(2000-) ； VW-Fox(2005-) 、 Polo_(Front) (2002-) 、 PAS_(Front) ；
SKODA-Fabia(2000-) 、 Roomster SEAT- Ibiza(2002-)、 Cordoba (6L)



Removing:



Insertion:



Dismounting (拆)

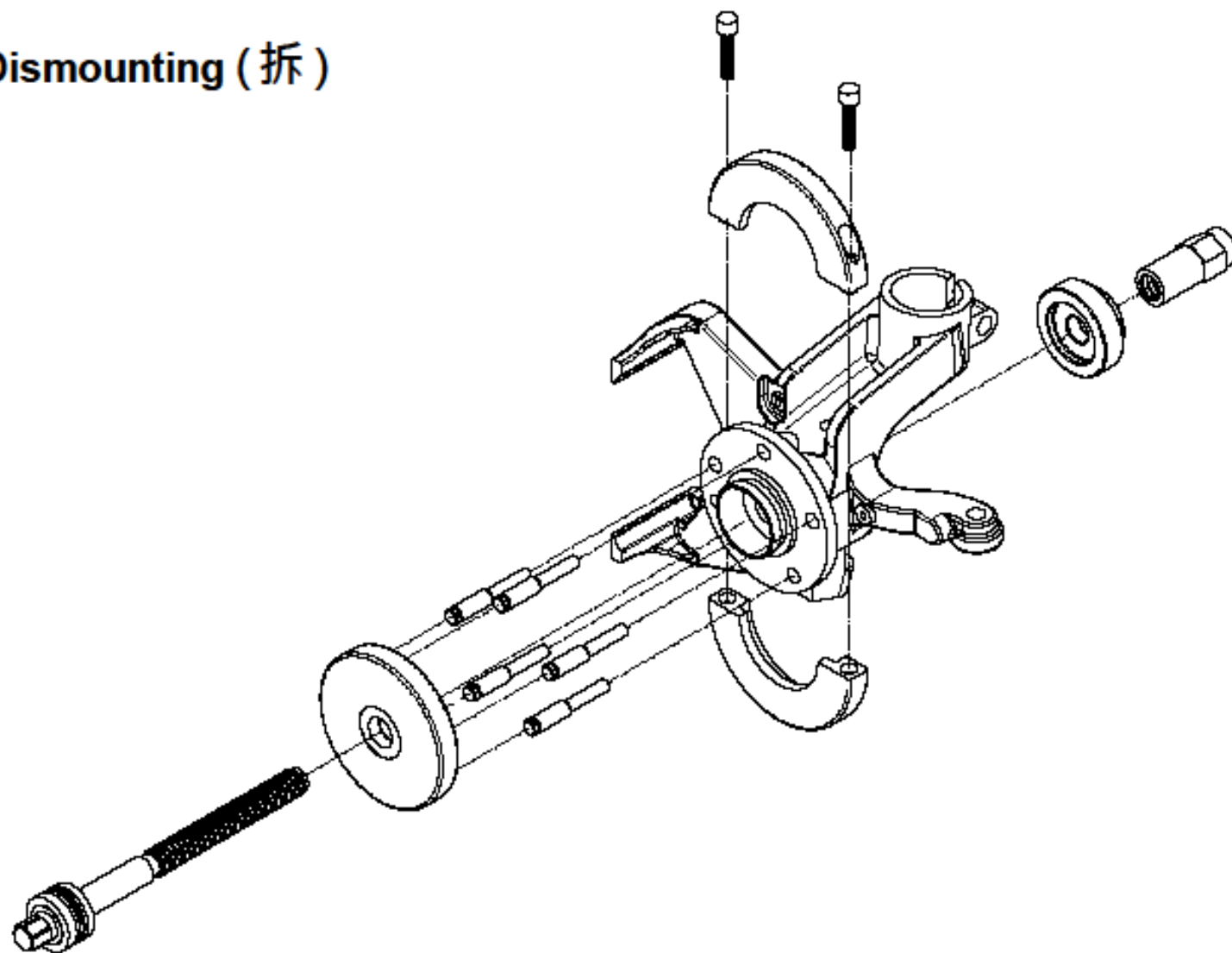

Assembling (装)

